

FOUNDATION PLAN  
SCALE: 1/4"=1'-0"

- FOUNDATION PLAN NOTES:
1. ALL FOUNDATION WALLS TO BE CONCRETE ON GRADE.
  2. ALL FOUNDATION WALLS TO BE 12" THICK UNLESS NOTED OTHERWISE.
  3. ALL FOUNDATION WALLS TO BE REINFORCED WITH #4 @ 16" O.C.
  4. ALL FOUNDATION WALLS TO BE FINISHED WITH 1/2" GYPSUM BOARD.
  5. ALL FOUNDATION WALLS TO BE PAINTED WITH 2 COATS OF EXTERIOR GRADE PAINT.
  6. ALL FOUNDATION WALLS TO BE FINISHED WITH 1/2" GYPSUM BOARD.
  7. ALL FOUNDATION WALLS TO BE FINISHED WITH 1/2" GYPSUM BOARD.
  8. ALL FOUNDATION WALLS TO BE FINISHED WITH 1/2" GYPSUM BOARD.
  9. ALL FOUNDATION WALLS TO BE FINISHED WITH 1/2" GYPSUM BOARD.
  10. ALL FOUNDATION WALLS TO BE FINISHED WITH 1/2" GYPSUM BOARD.
  11. ALL FOUNDATION WALLS TO BE FINISHED WITH 1/2" GYPSUM BOARD.
  12. ALL FOUNDATION WALLS TO BE FINISHED WITH 1/2" GYPSUM BOARD.

| STATISTICS:        |                     |
|--------------------|---------------------|
| AREA:              | EXISTING: PROPOSED: |
| FIRST FLOOR AREA:  | N/A 1,922 S.F.      |
| SECOND FLOOR AREA: | N/A N/A             |
| TOTAL LIVING AREA: | N/A 1,922 S.F.      |
| BASEMENT AREA:     | N/A N/A             |
| GARAGE AREA:       | N/A 480 S.F.        |
| TOTAL AREA:        | N/A 2,402 S.F.      |

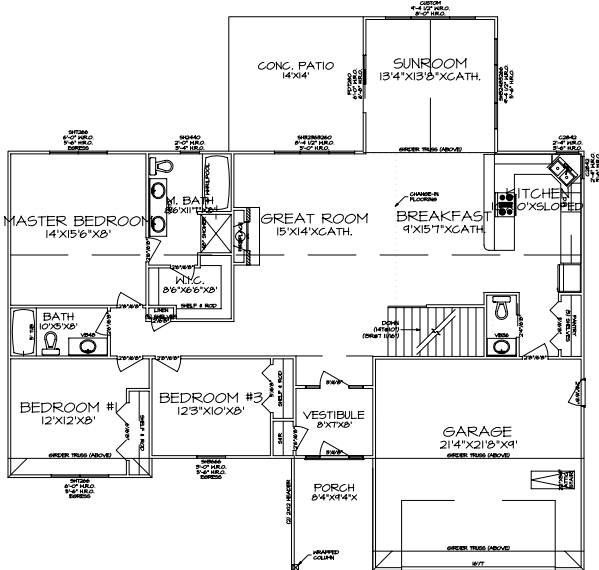

FIRST FLOOR PLAN  
SCALE: 1/4"=1'-0"

- FLOOR PLAN NOTES:
1. ALL INTERIORS TO BE 5/8" DRYWALL.
  2. ALL INTERIORS TO BE PAINTED WITH 2 COATS OF INTERIOR GRADE PAINT.
  3. ALL INTERIORS TO BE FINISHED WITH 1/2" GYPSUM BOARD.
  4. ALL INTERIORS TO BE FINISHED WITH 1/2" GYPSUM BOARD.
  5. ALL INTERIORS TO BE FINISHED WITH 1/2" GYPSUM BOARD.
  6. ALL INTERIORS TO BE FINISHED WITH 1/2" GYPSUM BOARD.
  7. ALL INTERIORS TO BE FINISHED WITH 1/2" GYPSUM BOARD.
  8. ALL INTERIORS TO BE FINISHED WITH 1/2" GYPSUM BOARD.
  9. ALL INTERIORS TO BE FINISHED WITH 1/2" GYPSUM BOARD.
  10. ALL INTERIORS TO BE FINISHED WITH 1/2" GYPSUM BOARD.
  11. ALL INTERIORS TO BE FINISHED WITH 1/2" GYPSUM BOARD.
  12. ALL INTERIORS TO BE FINISHED WITH 1/2" GYPSUM BOARD.

GALLIVAN'S  
DRAFTING & DESIGN  
(217) 202-5998